

Research and reconstruction of Wooden Ships



01.02 Final Project

Filipe Castro
Last edited: June 2020

Final Project

Written Portion in *PowerPoint* (8.5 x 11 in.), or in *Publisher*;
Hull Analysis presented with partial calculations and drawings;
Lines drawings and construction drawings scanned.

Final Project

1. A complete set of lines;
2. Hull calculations;
3. Construction plans:
 - a. Longitudinal section;
 - b. Two transverse sections (one at the widest point on the hull);
 - c. Plan of main deck.

Final Project

1. It must be built of wood.
2. No dugouts, rafts, birch bark canoes, etc.
3. No pleasure craft.
4. It must be at least 10 meters long, but no more than 40 meters.
5. It should not have elaborate castles or deck structures.
6. It may not be a specific vessel for which plans already exist, or a direct copy of such.

Final Project

Checklist for submission:

- ☐ Drawings (lines, construction, deck)
- ☐ Title blocks on all drawings
- ☐ Written analysis and bibliography
- ☐ Principal dimensions
- ☐ Scantling list
- ☐ Calculated displacement and hull coefficients (with worksheets showing calculations)

Written portion:

A short-written report, about 2,000 words. Presented in the IJNA format, Times New Roman 12, 1.5 line spacing, no indented paragraphs, 6 points after every paragraph, with a cover, blank last page, and bound:

1. Introduction
2. Description of the vessel chosen
3. Research
4. Final result
5. Hull Analysis
 1. Principal dimensions
 2. Scantling list
 3. Hull calculations
 4. Coefficients
6. References

Final Project Examples

Classical oared craft (c. 500 – c. 200 BCE)

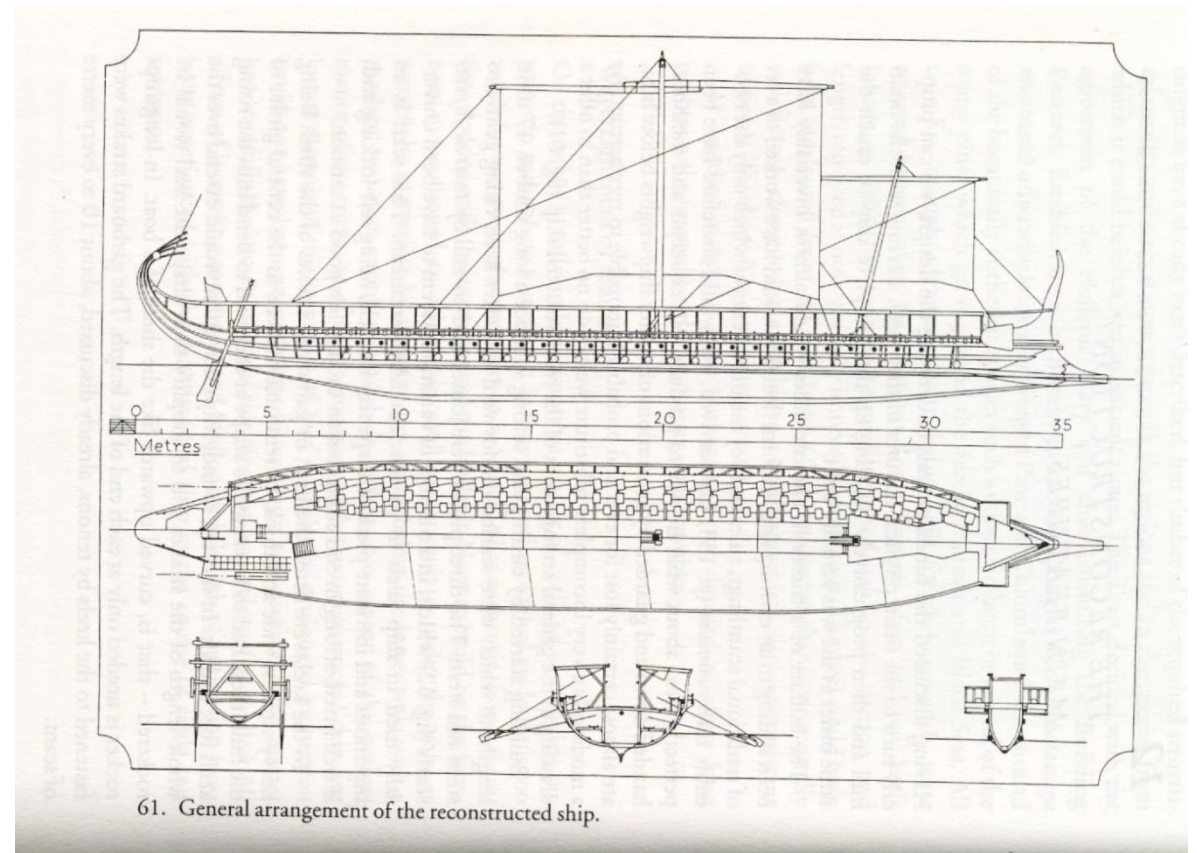

Final Project



Ma'agan Michael (c. 400 BCE)

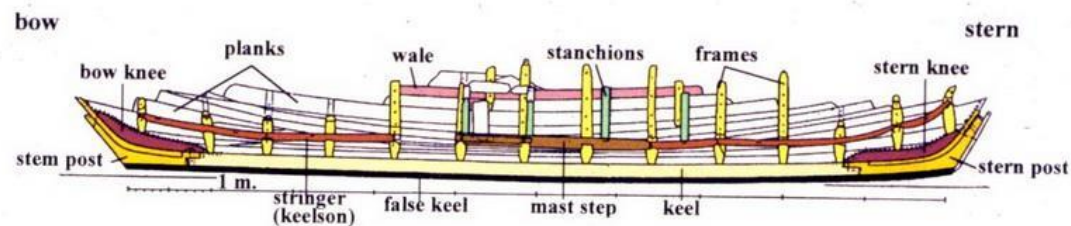

Maagan Mikhael Ship

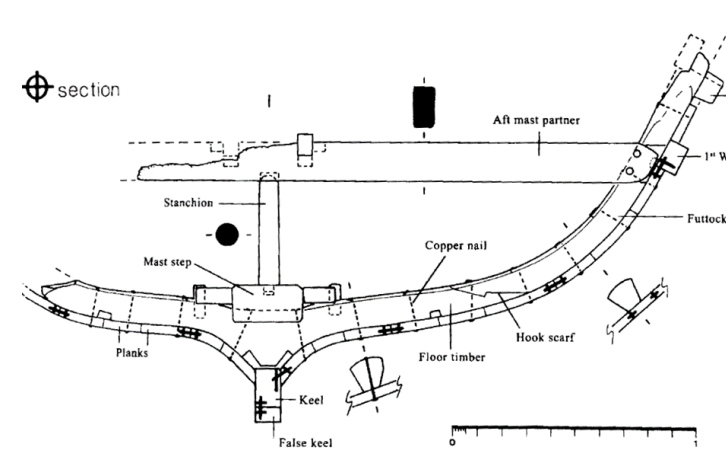
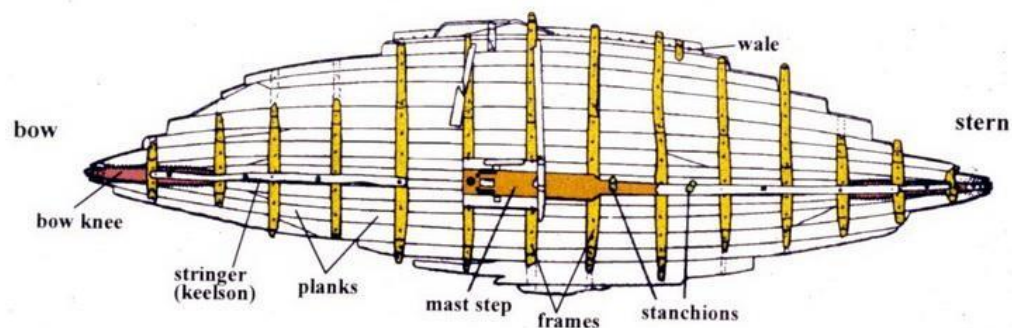
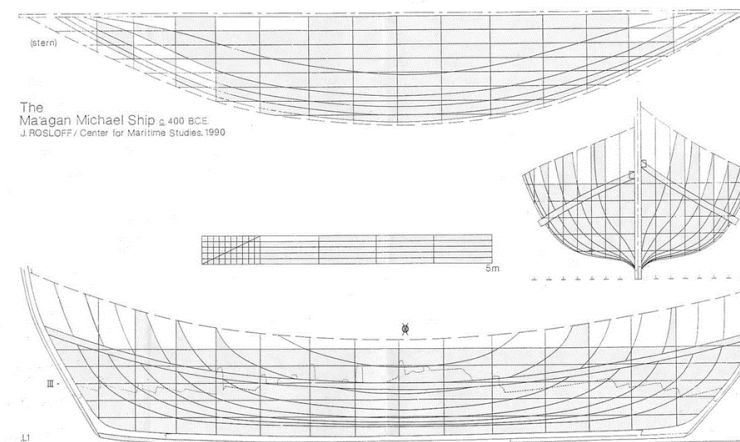

Fig. 3. Cross-section. (Preliminary drawing by J. Rosloff, updated by T. Levi)



Kyrenia (c. 300 BCE)

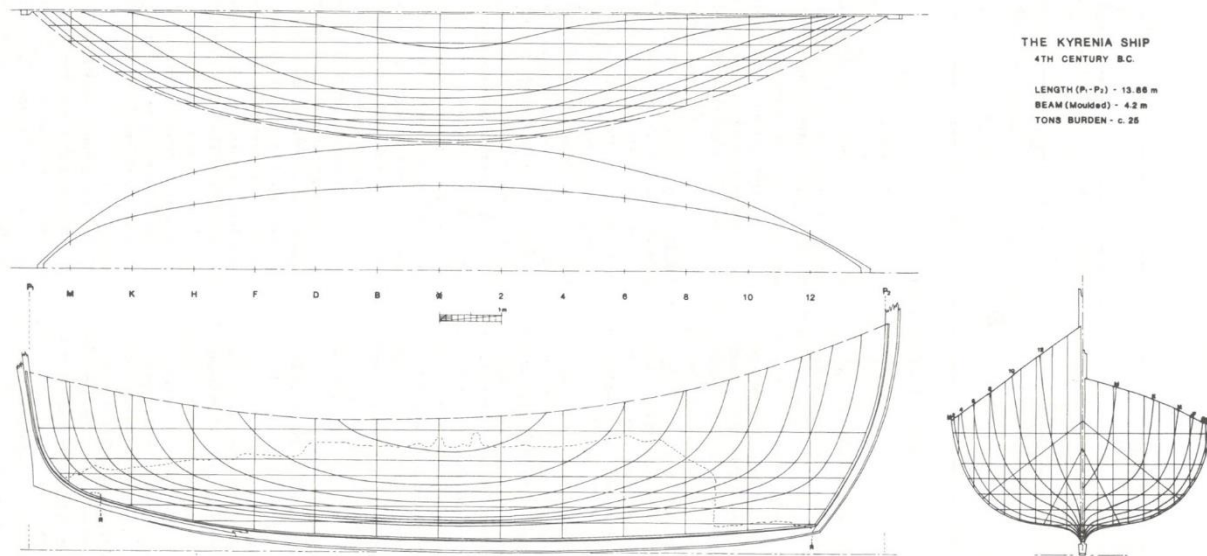

FIG. 3-38. The lines of the Kyrenia ship.

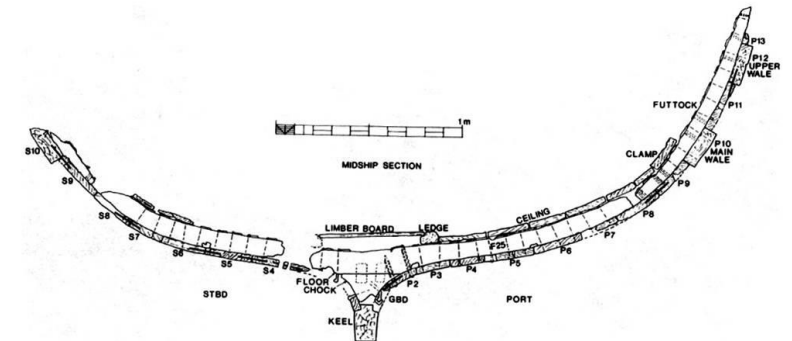
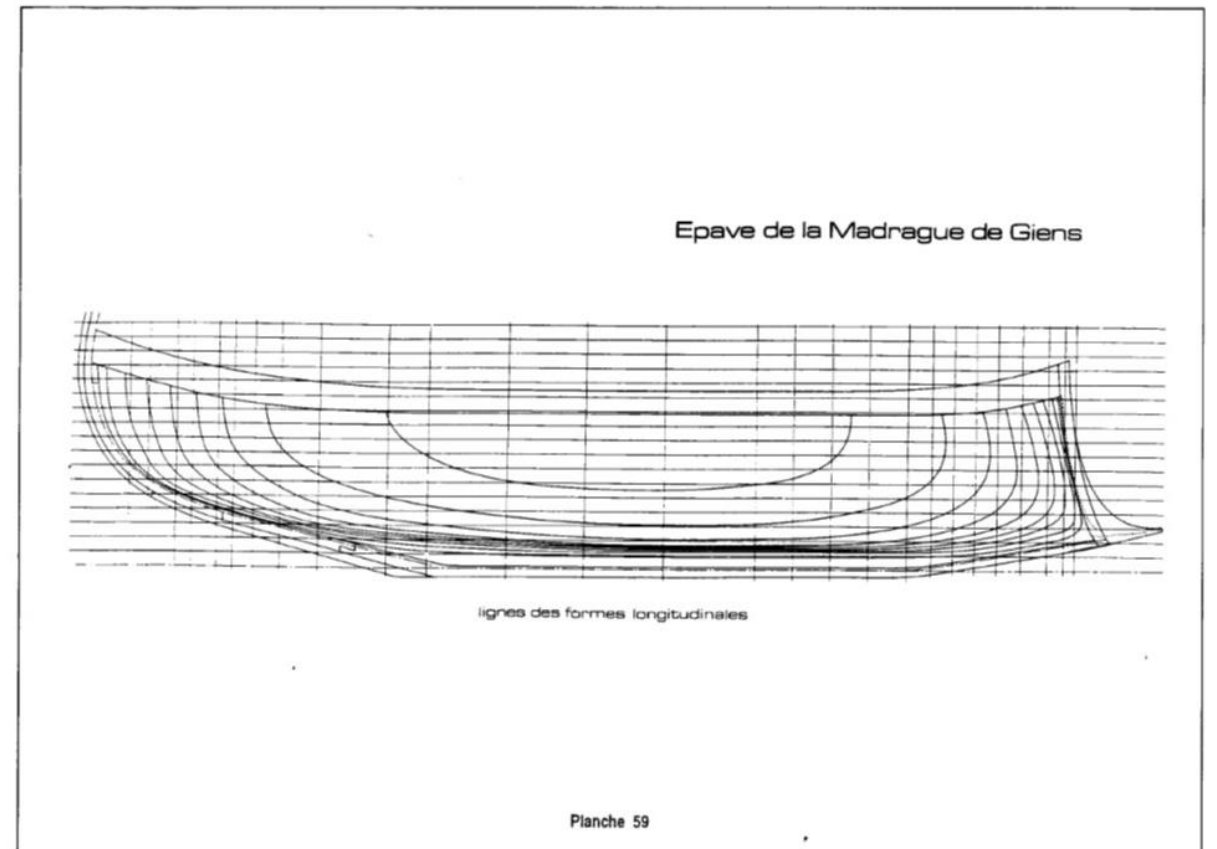
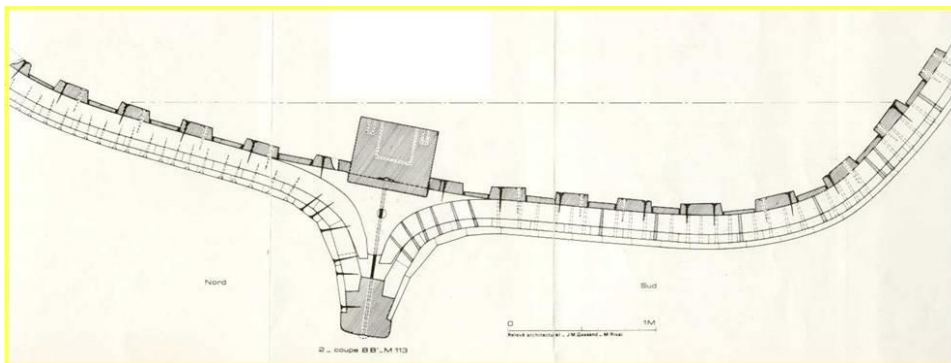
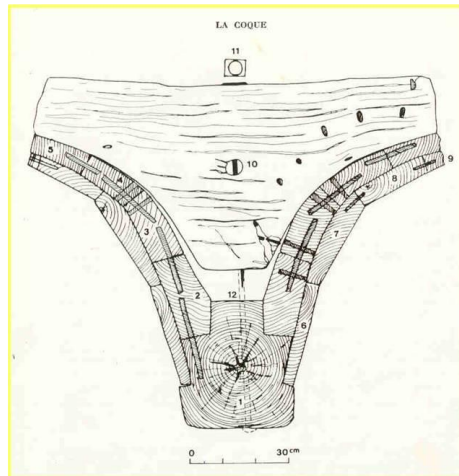

FIG. 3-31. Cross section of the Kyrenia ship's hull at amidships.

Final Project

Madrague de Giens (c. 60 BCE)



Final Project



Anse des Laurons II (c. AD 200)

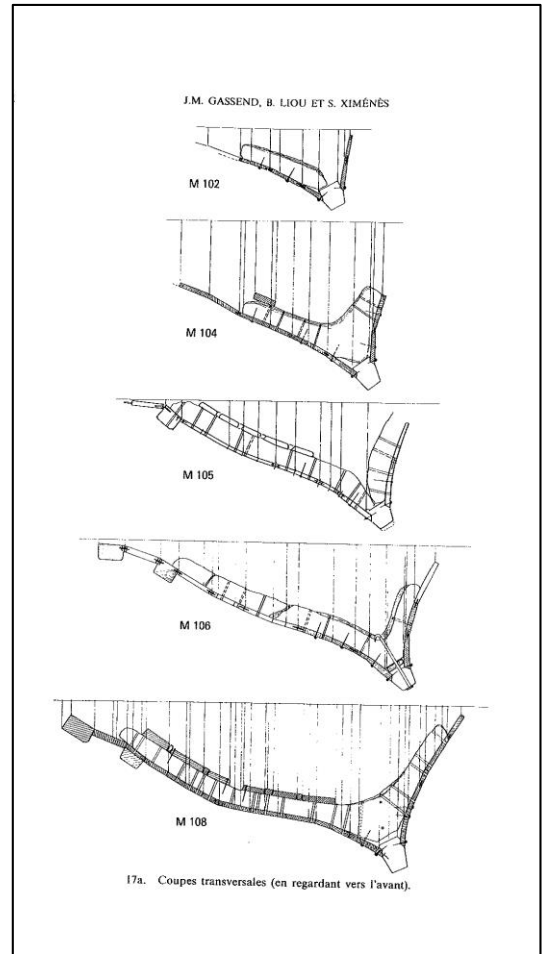
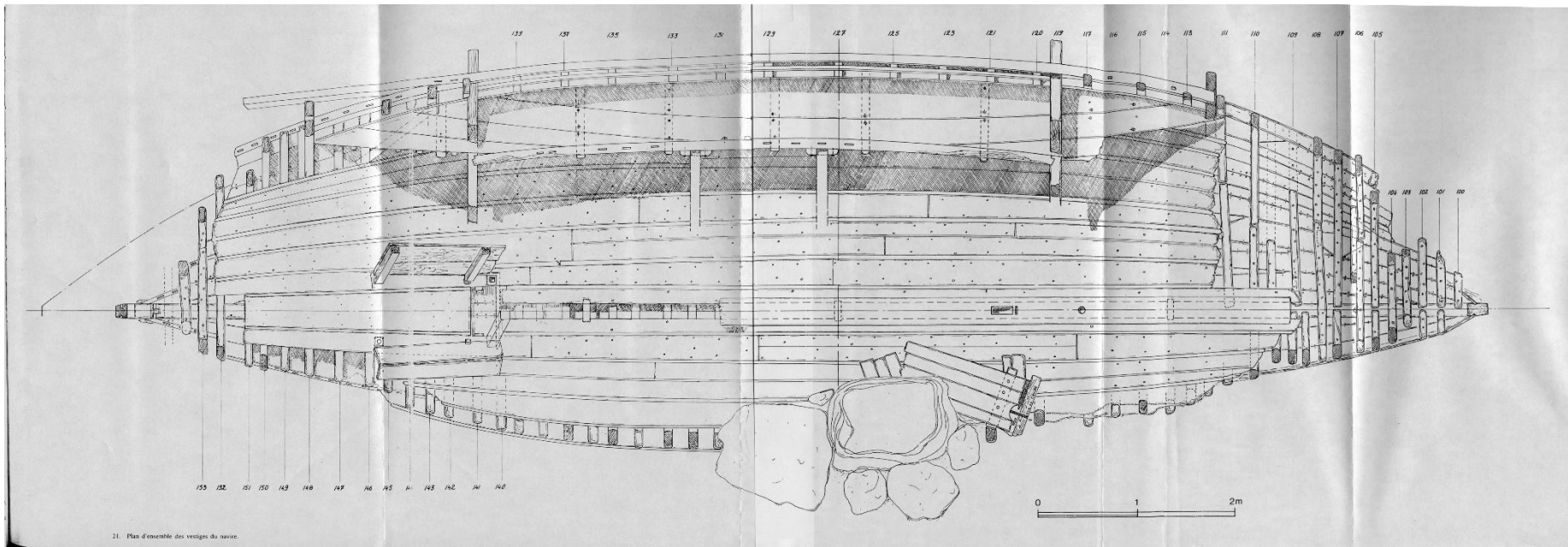

Final Project



Cais do Sodré (c. 1500)

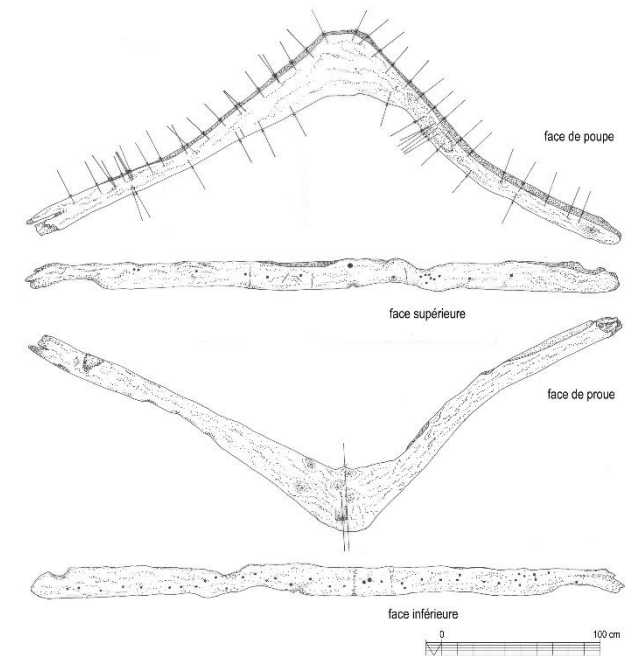
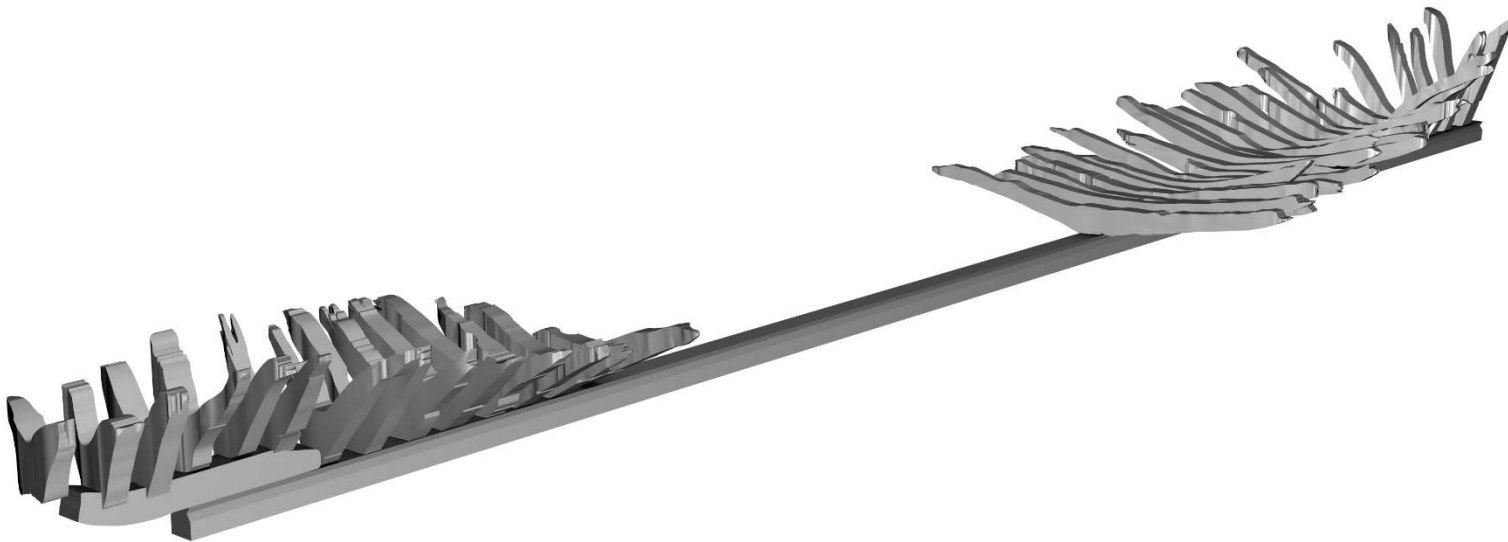

Final Project



Aveiro A (c. 1450)

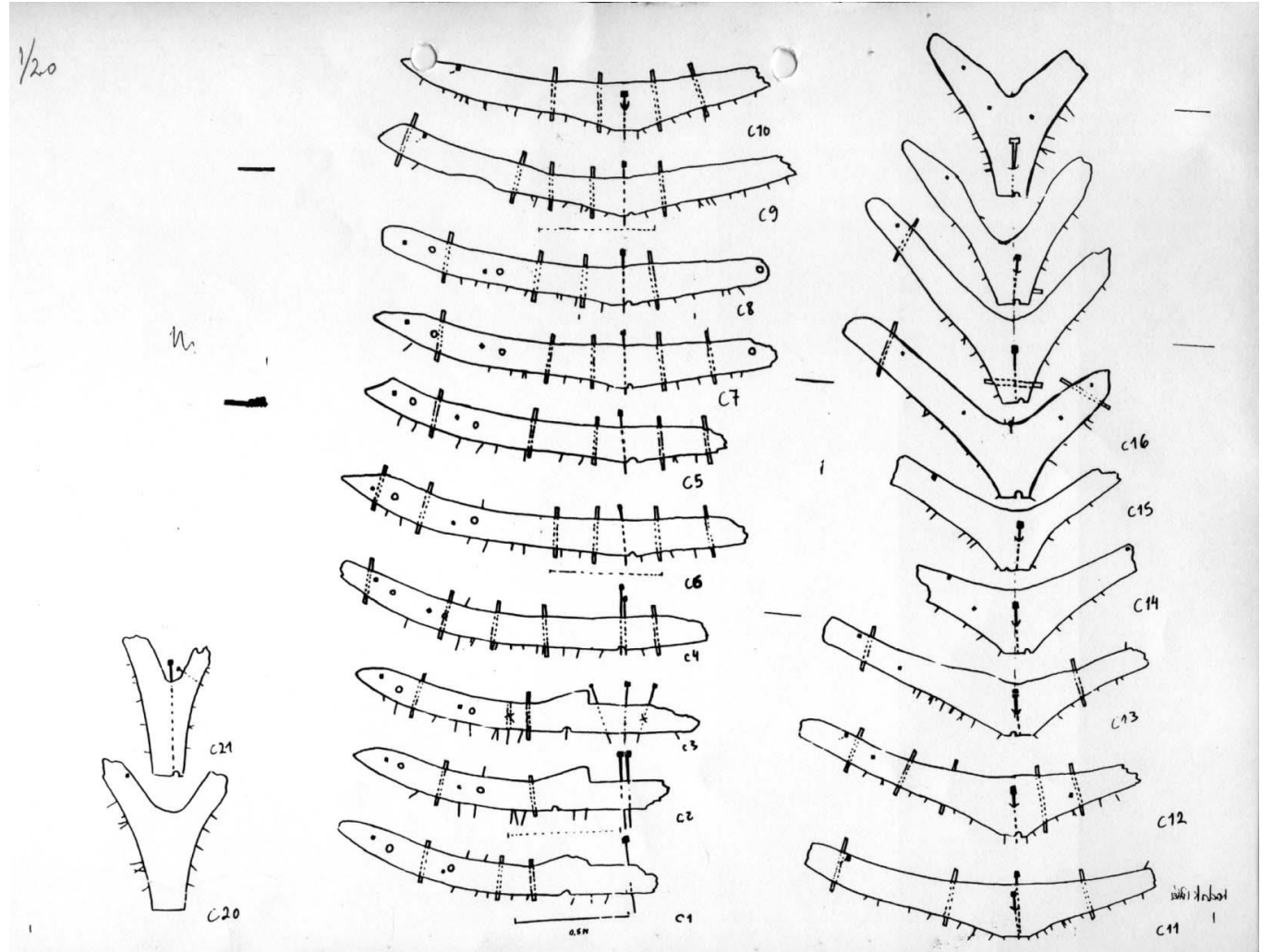
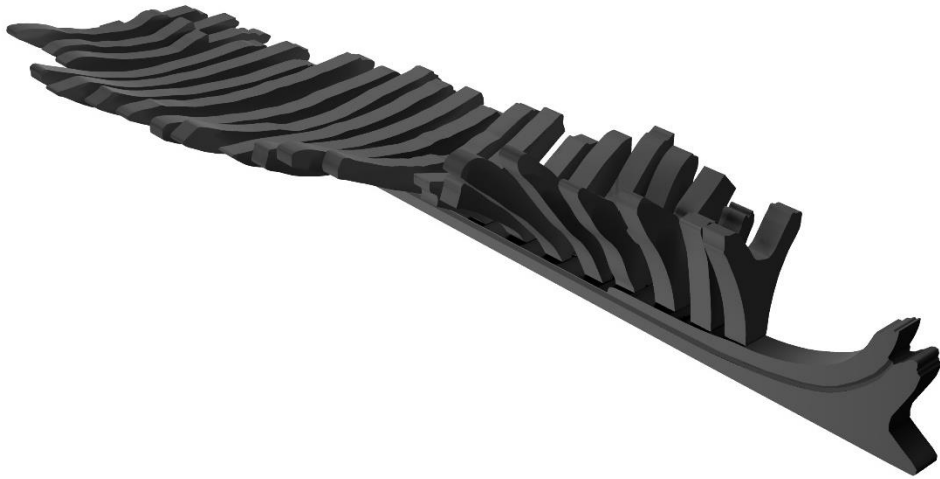

...or Calvi 1, or *Lomelina*

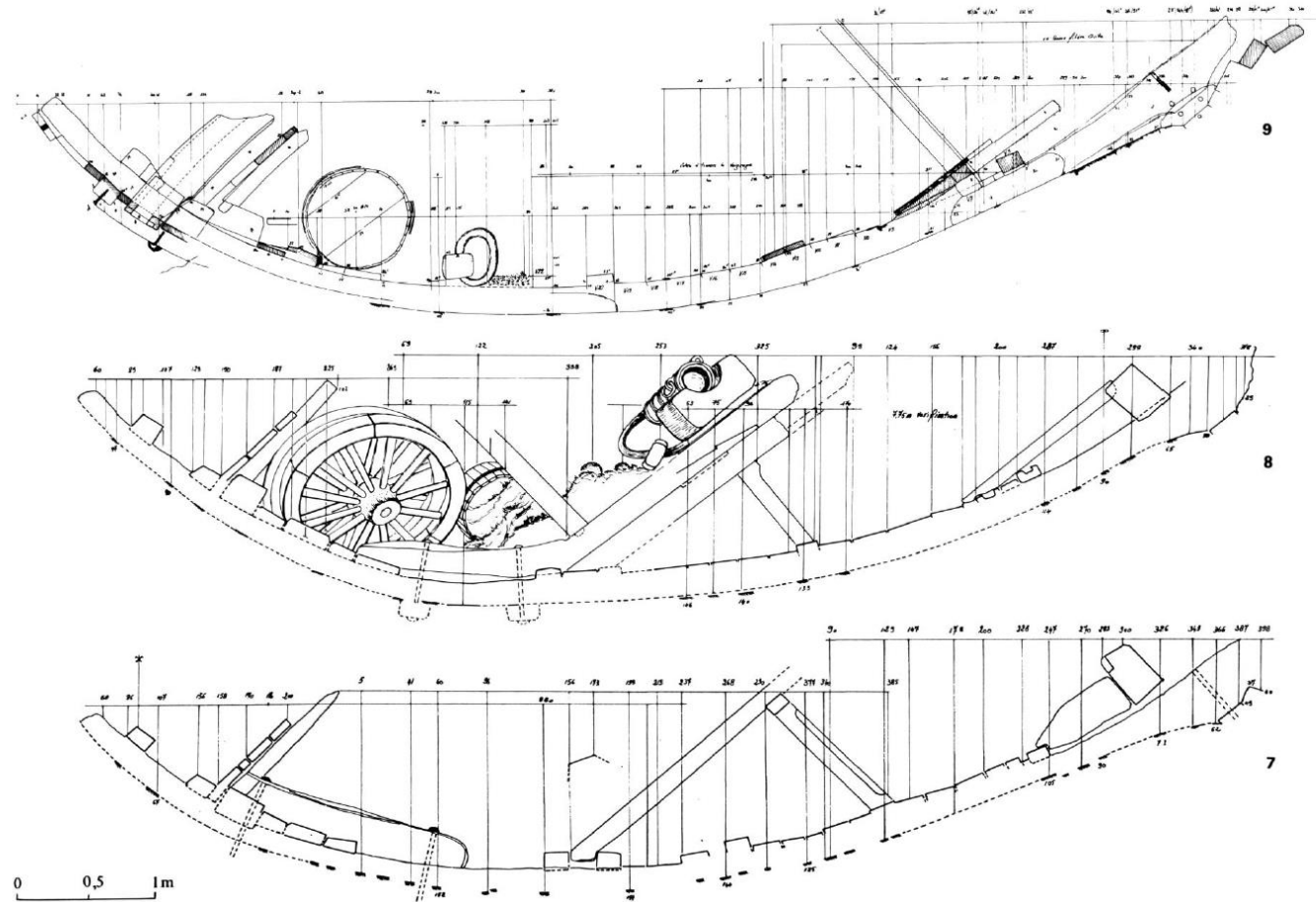

RESTITUTION DE LA CARÈNE

Contents

A short-written report, about 2,000 words. Presented in the IJNA format, Times New Roman 12, 1.5 line spacing, no indented paragraphs, 6 points after every paragraph, with a cover, blank last page, and bound:

1. Introduction
2. Description of the vessel chosen
3. Research (include iconographical research)
4. Final result – Conclusion (scan the lines drawings and construction drawings and include them in this section of your report)
5. Hull Analysis
 1. Principal dimensions
 2. Scantling list
 3. Hull calculations
 4. Coefficients
6. References